

Second stage of works commence

Following the completion of the new hospital in November 2020, the redevelopment project has been progressing with the second stage of works.

This has included the removal of the old hospital buildings to make way for the new staff accommodation building, internal access roads and final landscaping. The project remains on track to be completed by mid-year.

We are still planning on holding a community event to welcome the new hospital and celebrate the completion of the project around mid-year. The community event will be in line with the health guidelines and restrictions that are in place at the time, and we will release the details of this community event closer to the time. Thanks for your ongoing patience and support.



Aerial photograph of the hospital site in late January 2021

Arts and heritage update

Incorporating arts and heritage into the new hospital campus has been a focus of the project. Completed work includes the display of historical medical items and plaques within the new hospital's waiting room, as well as a timeline showing the history of the local health service.

The new water tanks have received a transformation with local artist Anita Faulkner painting a mural. The artwork was developed in collaboration with Murrurundi Public School students. Watch our short video to find out more about the community arts projects:

www.mps.health.nsw.gov.au/projects/murrurundi

Welcome artwork has been installed in the new hospital's entry area, and local photography is being framed for display in the two patient corridors. Heritage information boards are also being manufactured and will be installed at the entrance to the new hospital. We look forward to providing more detail on these important pieces.



Images inspired by students painted onto new water tanks



First patient in new hospital

Following the completion of construction and transfer of services, the new Wilson Memorial Hospital opened to the public on 11 November.

The first inpatient to be admitted to the new hospital had a special connection to the health service and Murrurundi. Ethel Maud Haydon was also the last patient in the old hospital and was transferred over to the new hospital on the first day of operations.

While a patient in the old hospital, Ethel stayed in the same room where her grandson Henry was born and fondly recalled many local memories.

Ethel celebrated her 100th birthday in June last year and is recognised as a member of the pioneering Haydon family who established Bloomfield in 1832 and Haydonton which is now amalgamated with Murrurundi.

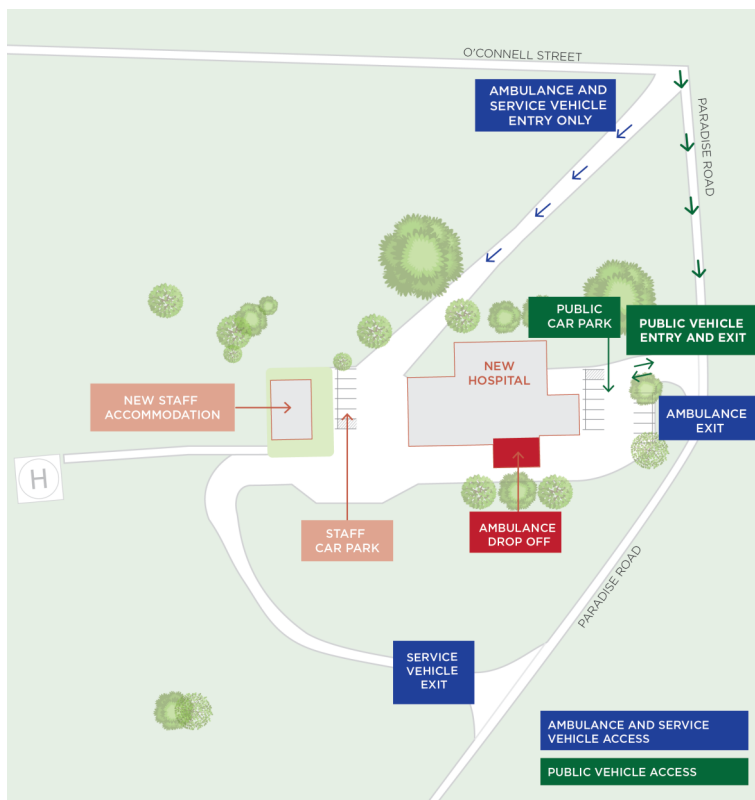

Map showing the layout of the new hospital campus



Ethel Haydon, the first patient in the new hospital

Learn more about your new hospital

To help familiarise the community with their new hospital, a video and brochure can be found here:

www.mps.health.nsw.gov.au/projects/murrurundi www.mps.health.nsw.gov.au/projects/murrurundi

The brochure was also letterbox dropped to all residents in December 2020, and additional hard copies can be obtained from the hospital.