

Aboriginal Courtyard in construction

Locals will have seen construction underway on the Aboriginal Courtyard at the front of the new Cobar Health Service.

The design was developed during late 2018 and 2019 by a local working group established to work with the landscape architect and wider project team.

The design reflects local culture and includes materials suitable to local conditions. It's hoped the courtyard will provide a place for healing, inclusion and reflection.

The design incorporates seating areas for males and females, linked using the semi-circle formation – the image below shows this design feature. There will also be a shade structure over the seating area.

The plants have been selected for their suitability to the local conditions and include Weeping Myalls, a Kurrajong, Bottle Brush, Emu Bush, Mat Rush, Flax Lily and Turf Lily (see images over). Due to current water restrictions the plantings and proposed grass areas have been modified, with irrigation installed to allow future plantings (once it has rained significantly!).

Thank you to the local working group for your commitment to ensuring the courtyard strongly represents the local community and culture.

The new health service also includes local Aboriginal language on signage and local art—we look forward to giving the community a sneak peek at the facility in early 2020.

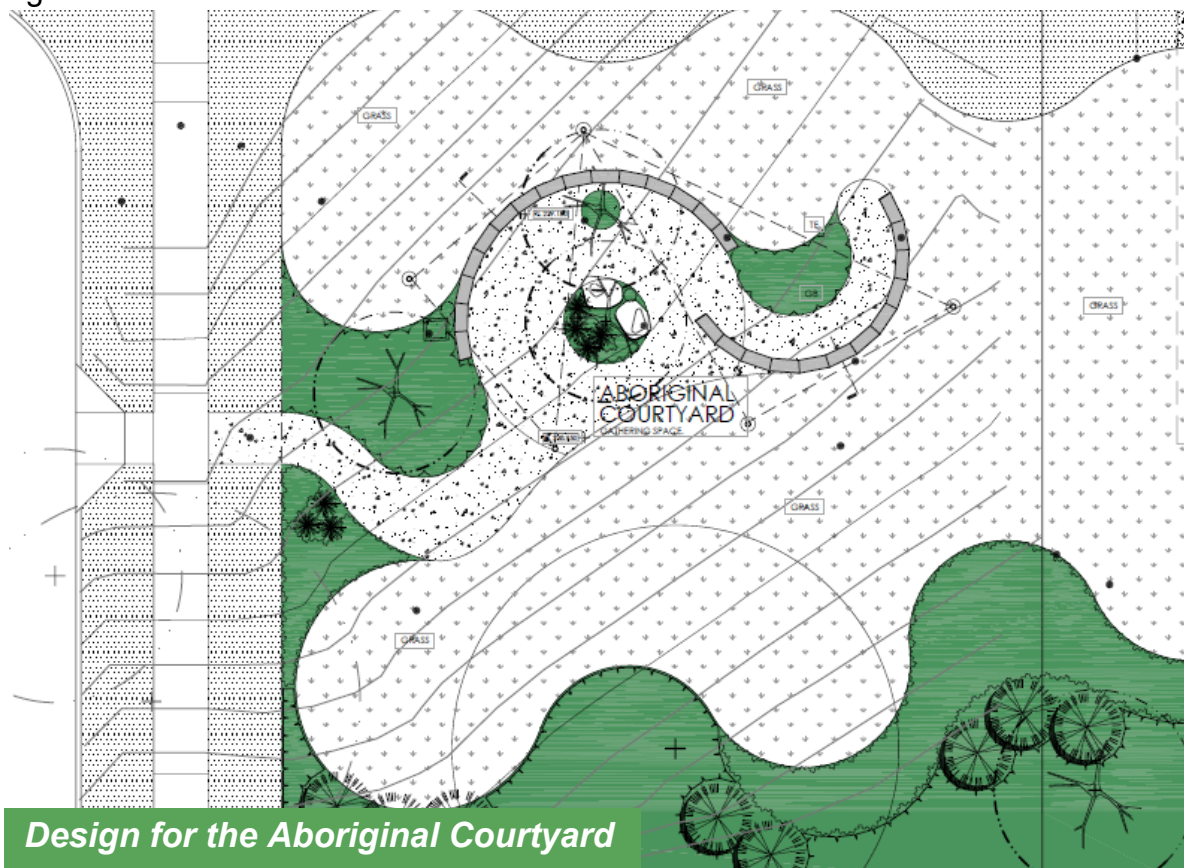

Design for the Aboriginal Courtyard



Aboriginal Courtyard plantings and materials

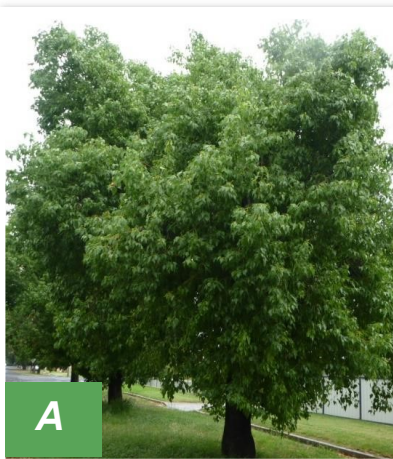

A



B



First working group meeting, Aug 2018



C



D



Working group meeting, Feb 2019



E



F

A–Kurrajong, B–Weeping Myall, C–Flax Lily, D–Emu Bush, E–Mat Rush, F– Example of seating materials

